

CORNER27 G/UX

CORNER PROFILE / PROFIL KĄTOWY

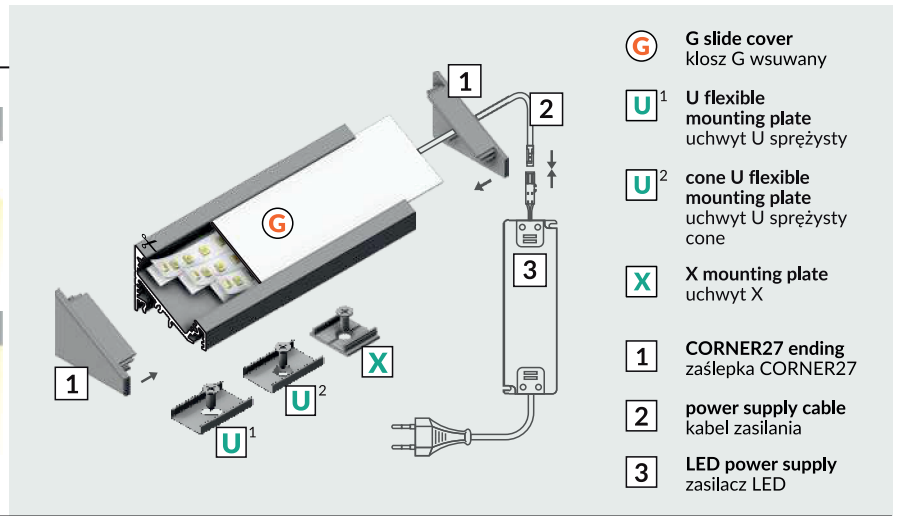
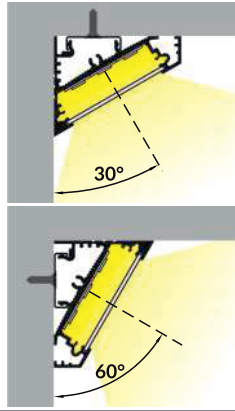
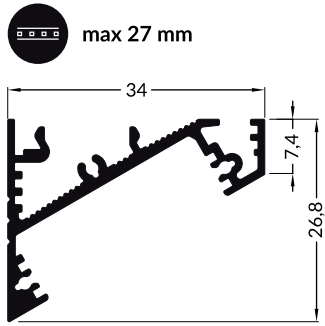

- G** G slide cover klosz G wsuwany
- U¹** U flexible mounting plate uchwyty U sprężysty
- U²** cone U flexible mounting plate uchwyty U sprężysty cone
- X** X mounting plate uchwyty X
- 1** CORNER27 ending zaślepka CORNER27
- 2** power supply cable kabel zasilania
- 3** LED power supply zasilacz LED

- scissors nożyczki
- hacksaw piła
- pliers kombinerki
- solder cyna
- soldering iron lutownica
- screwdriver wkrętak
- drill wiertarka

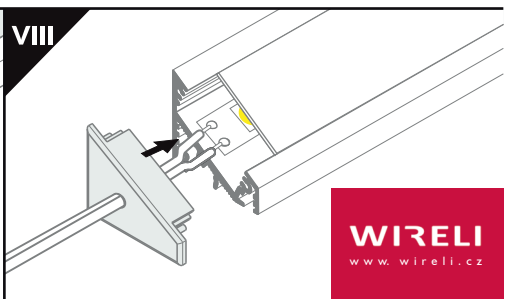
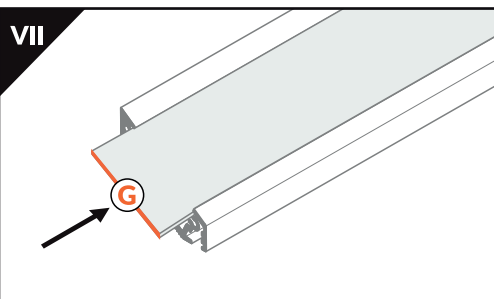
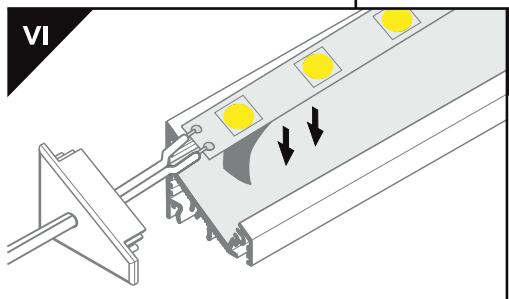
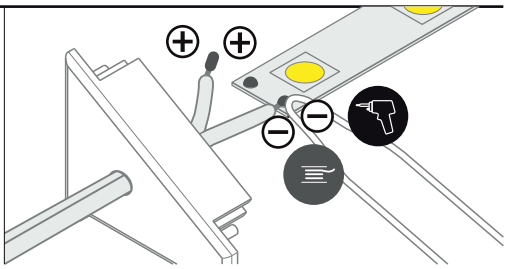
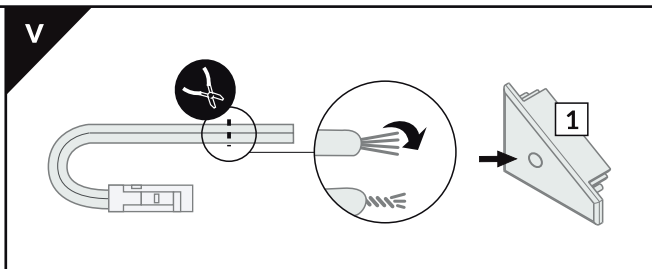
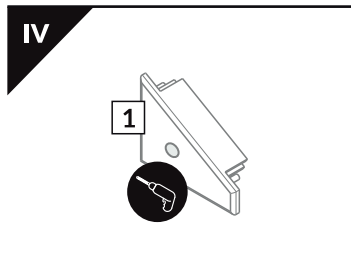
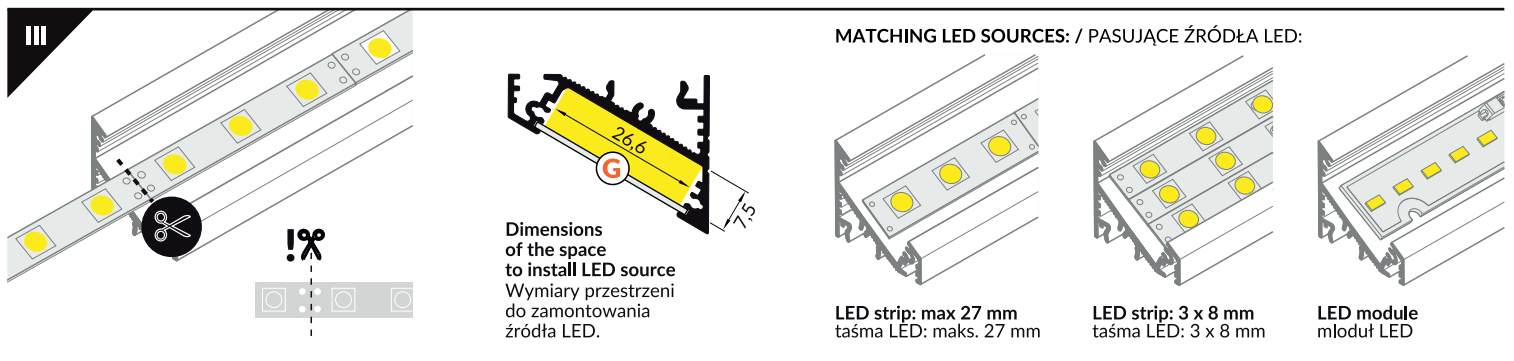
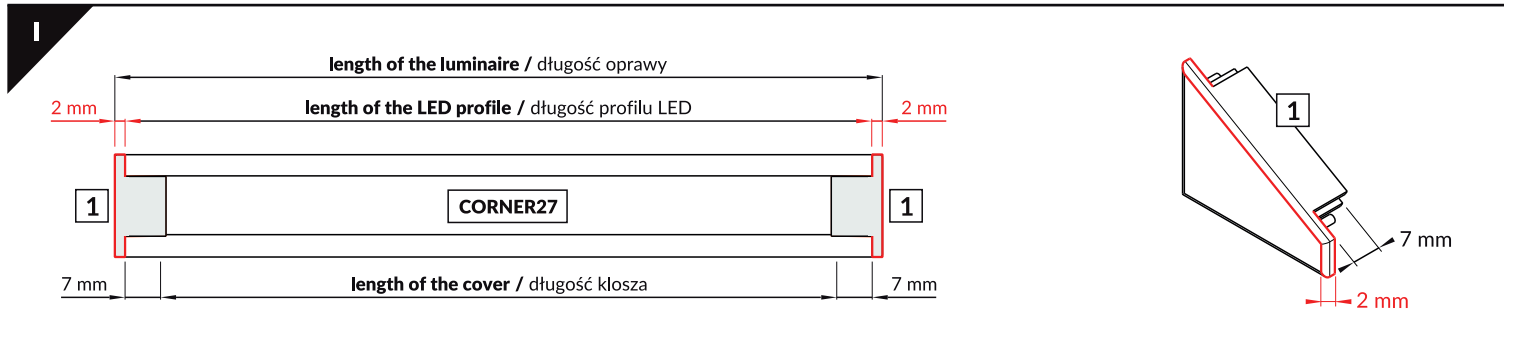

IX MOUNTING / MONTAŻ

U flexible mounting plate
uchwyt U sprężysty

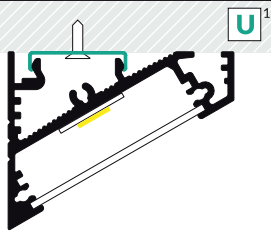

U¹

cone U flexible mounting plate
uchwyt U sprężysty cone

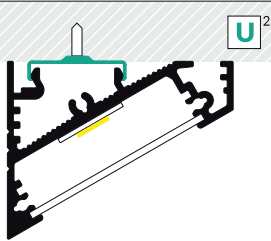

U²

X mounting plate
uchwyt X

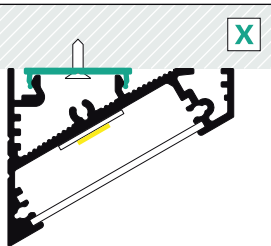

X

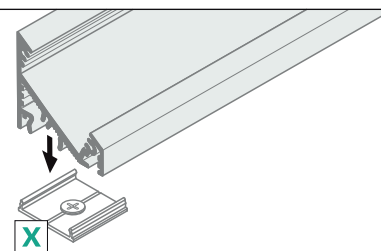
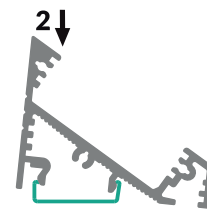
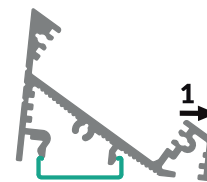
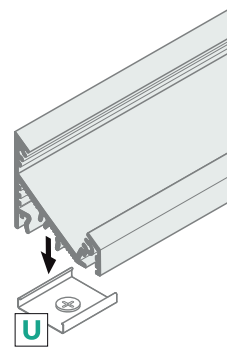
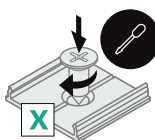
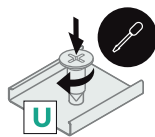

Other mounting possibilities: with mounting glue or mounting tape, with screws
Pozostałe możliwości montażu: na klej lub taśmę montażową, na wkręty

X POWER SUPPLY / ZASILANIE

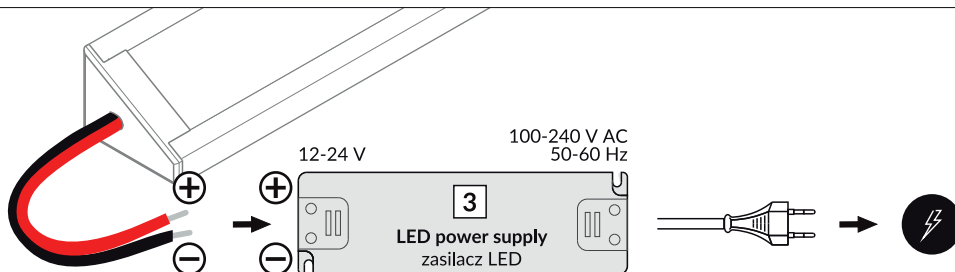

OPTIONAL ACCESSORIES / AKCESORIA OPCJONALNE



Mount the connector before installing the LED strip. In case there is no possibility of sliding the profile into connector it is recommended to mount with screws, directly to the mounting surface / Łącznik montować przed instalacją taśmy LED. W przypadku braku możliwości wsunięcia profilu w element łączący zalecany jest montaż na wkręty, bezpośrednio do powierzchni montażowej

X connector 180 deg
łącznik X 180 st

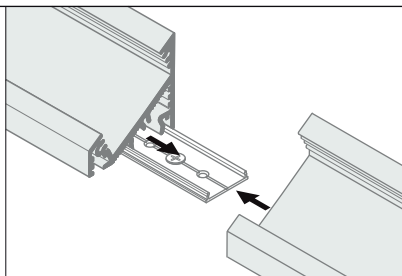
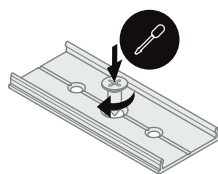

X connector may be used to make extra long profiles by connecting multiple profiles.
Łącznik X może być użyty do stworzenia pojedynczego bardzo długiego profilu.

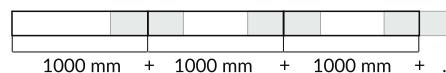

ACCESSORIES / AKCESORIA

power switches / włączniki
controller + remote / sterownik + pilot
movement sensors / czujniki ruchu