

VARIO30

RECESSED PROFILES PROFILE WPUSTOWE



scissors
nożyczki



hacksaw
piłka



glue
klej



drill
wiertarka



screwdriver
wkrętak







metal shears
nożyce do metalu



cotton gloves
rękawiczki

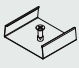
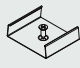
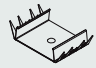
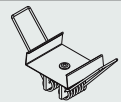

spatula
szpachelka

profiles profile	endings zaślepki	mountings mocowania			
 04 LED profile VARIO30-04 profil LED VARIO30-04	04				
 05 LED profile VARIO30-05 profil LED VARIO30-05	05				
 06 LED profile VARIO30-06 profil LED VARIO30-06	06	 U9 mounting plate uchwyt U9	 cone U9 mounting plate uchwyt U9 cone	 rack U9 mounting plate uchwyt U9 rack	 spring U9 mounting plate
 07 LED profile VARIO30-07 profil LED VARIO30-07	07				

I

VARIO30-04
VARIO30-05
diffuser / klosz
A9, C9, D9, E9

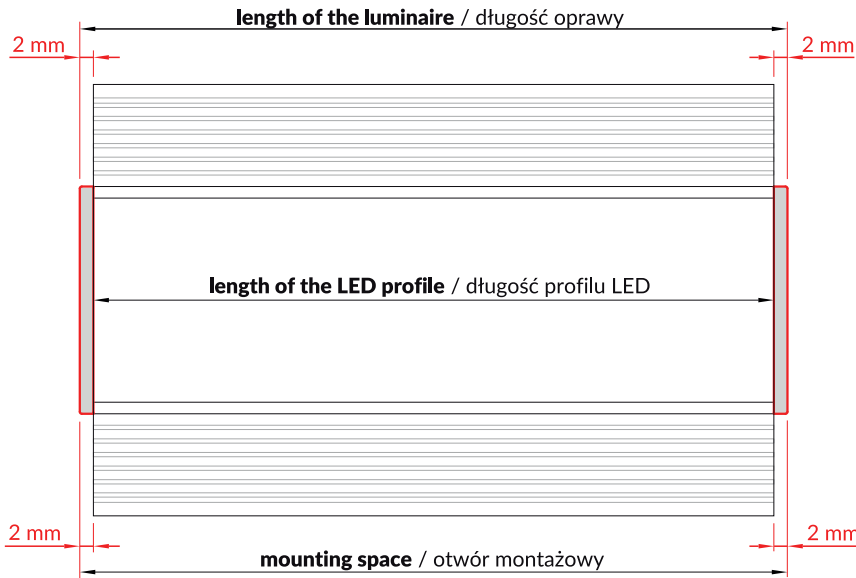

VARIO30-06 VARIO30-07 diffuser / klosz A9, C9, D9, E9

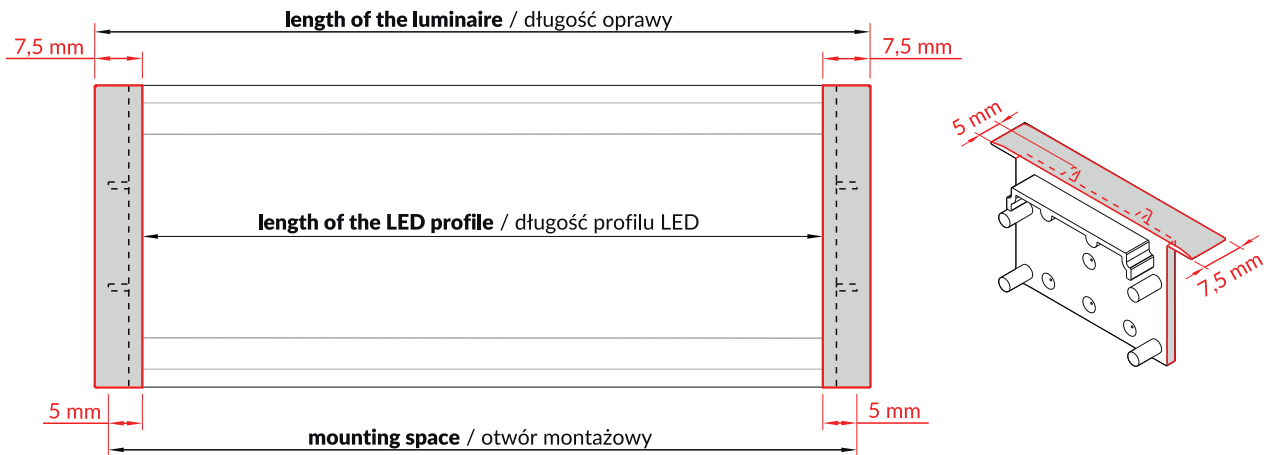

II

VARIO30-04
VARIO30-05
VARIO30-06
VARIO30-07
diffuser / klosz
A9, C9, D9, E9

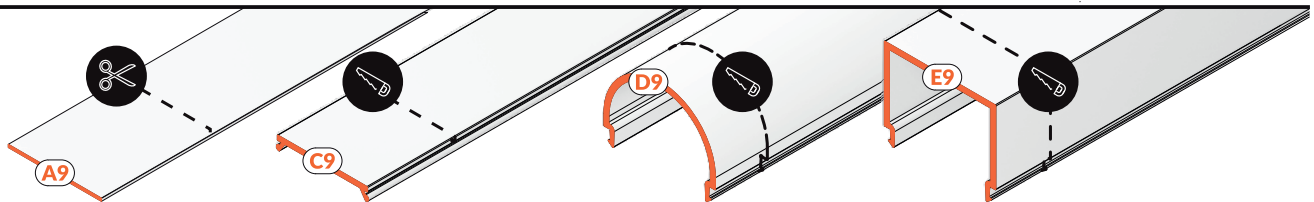

Note! The length of the cover is equal to the length of the profile.
Uwaga! Długość klosza równa jest długości profilu.

III

VARIO30-04
VARIO30-05
VARIO30-06
VARIO30-07
diffuser / klosz
A9, C9, D9, E9

RECOMMENDED LED MODULE
REKOMENDOWANY MODUŁ LED:
PHILIPS Fortimo LED strip LV

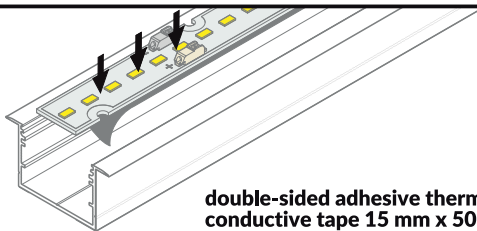

double-sided adhesive thermally conductive tape 15 mm x 50 m
taśma termoprzewodząca dwustronna 15 mm x 50 m

IV ACCESSORIES / AKCESORIA

VARIO30-04
VARIO30-06
diffuser / klosz
A9, C9, D9, E9

VARIO30 LED clamp
docisk LED VARIO30

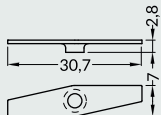

x 6 / 1 m

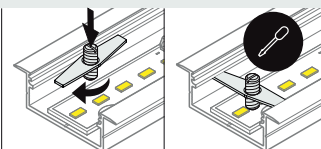
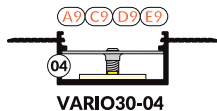

VARIO30-05
VARIO30-07
diffuser / klosz
A9, C9, D9, E9

VARIO30 LED mounting
mocowanie LED VARIO30

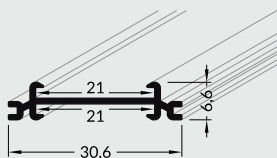

VARIO30 LED clamp
docisk LED VARIO30

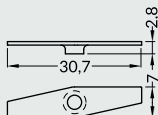

x 6 / 1 m

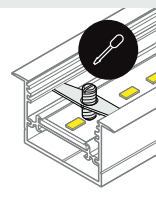
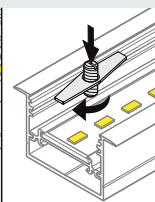
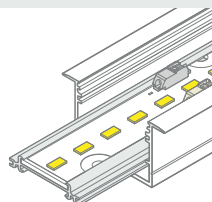
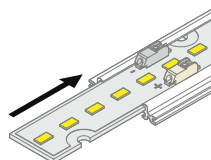
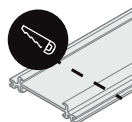
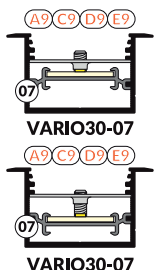
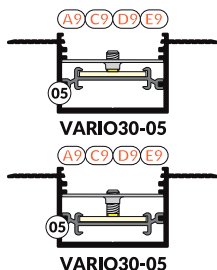

VARIO30-05
VARIO30-07
diffuser / klosz
A9, C9, D9, E9

VARIO30 LED 1 clamp
docisk LED VARIO30 1

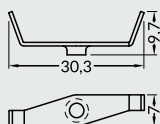

x 6 / 1 m

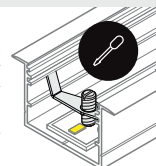
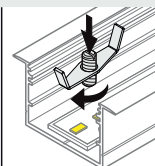
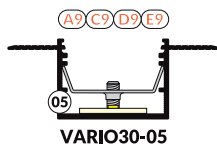

VARIO30-05
VARIO30-07
diffuser / klosz
A9, C9, D9, E9

VARIO30 reflector
odbłyśnik VARIO30

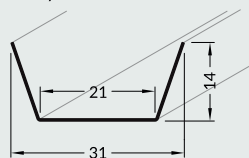

VARIO30 LED 1 clamp
docisk LED VARIO30 1

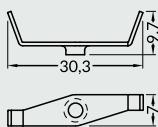

x 6 / 1 m

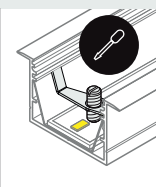
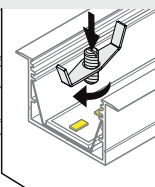
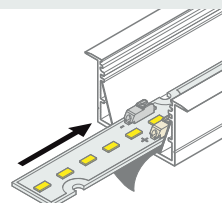
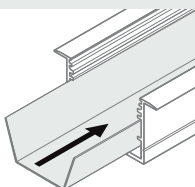
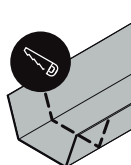
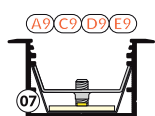
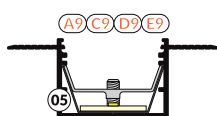

double-sided adhesive thermally conductive tape 15 mm x 50 m
taśma termoprzewodząca dwustronna 15 mm x 50 m

V

VARIO30-04
VARIO30-05
VARIO30-06
VARIO30-07
 diffuser / klosz
A9, C9, D9, E9

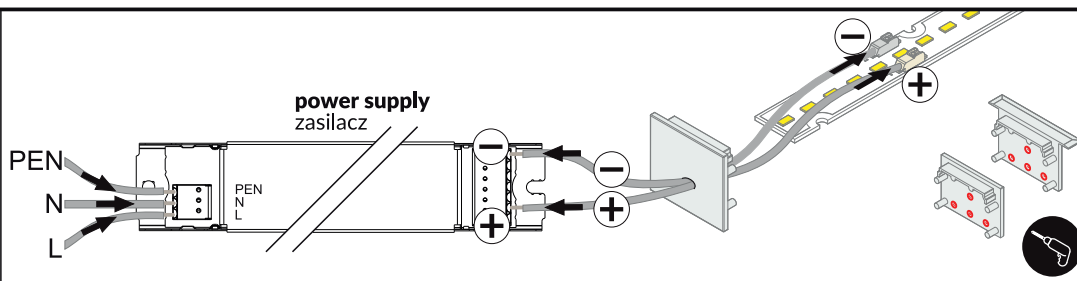

Note! Ending with marked space to bore the holes. Possibility of buying dedicated screws.
Uwaga! Zaślepka z punktami do przewiercenia otworów. Istnieje możliwość zakupu dedykowanych wkrętów.

VI

VARIO30-04
VARIO30-05
 diffuser / klosz
A9

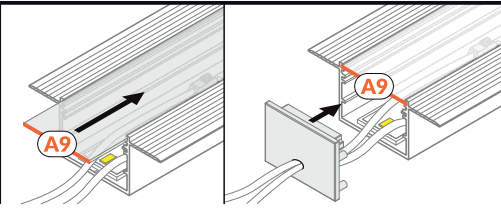

VARIO30-06
VARIO30-07
 diffuser / klosz
A9

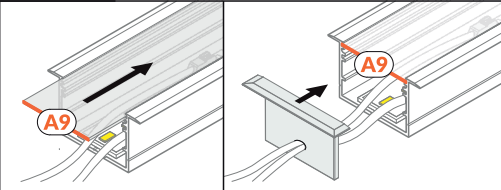

VARIO30-04
VARIO30-05
 diffuser / klosz
C9

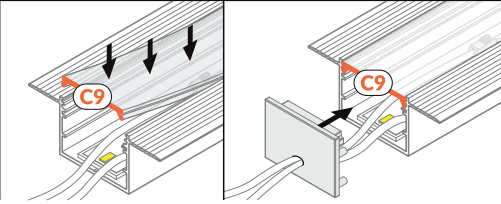

VARIO30-06
VARIO30-07
 diffuser / klosz
C9

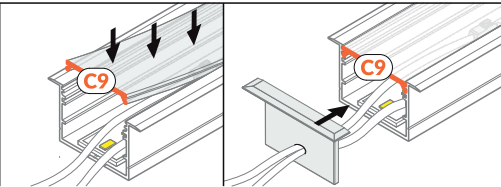

VARIO30-04
VARIO30-05
 diffuser / klosz
D9

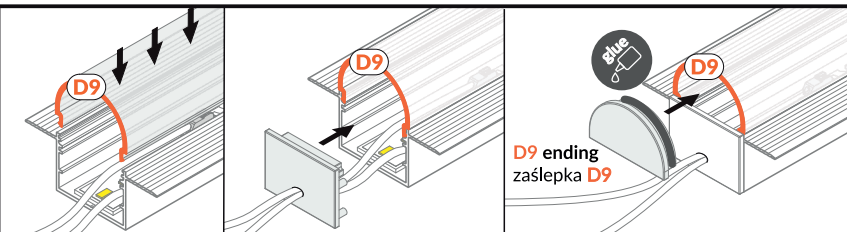

VARIO30-06
VARIO30-07
 diffuser / klosz
D9

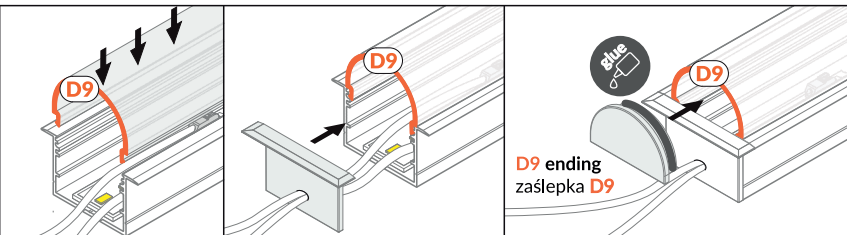

VARIO30-04
VARIO30-05
 diffuser / klosz
E9

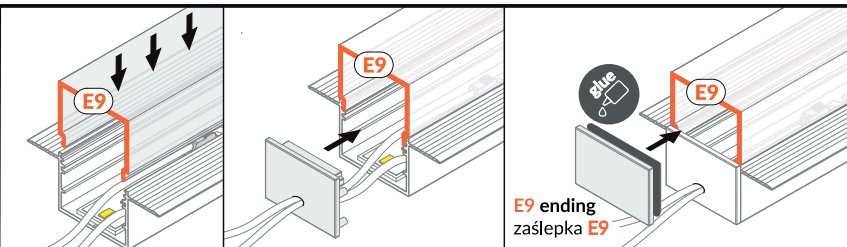

VARIO30-06
VARIO30-07
 diffuser / klosz
E9

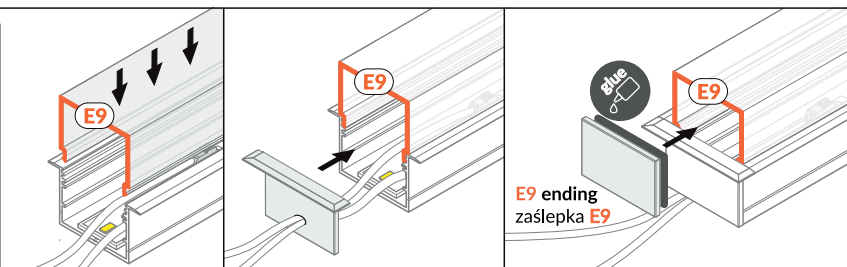

VARIO30-04
diffuser / klosz
A9, C9, D9, E9

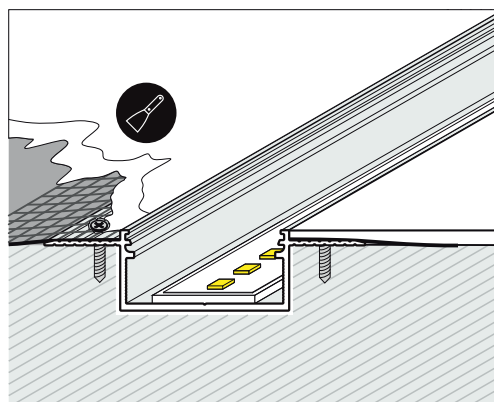
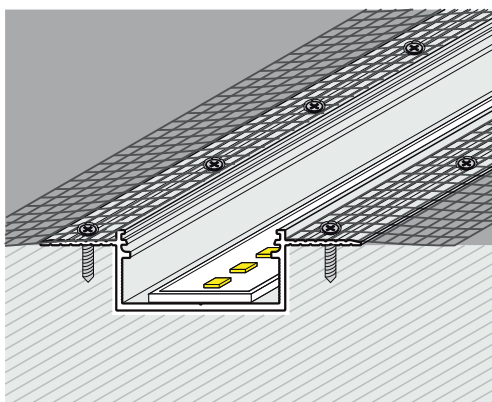
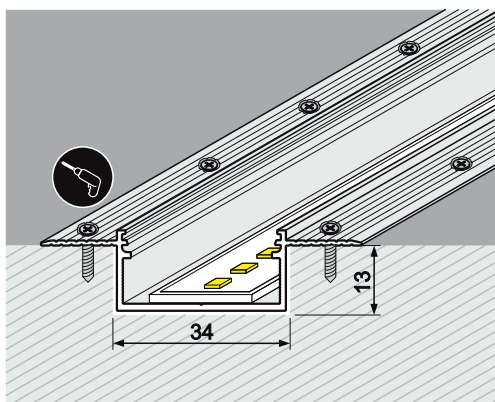

VARIO30-05
diffuser / klosz
A9, C9, D9, E9

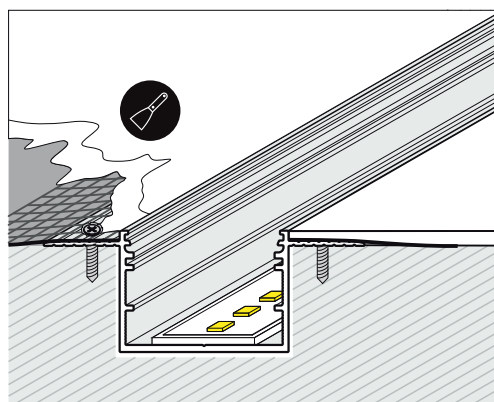
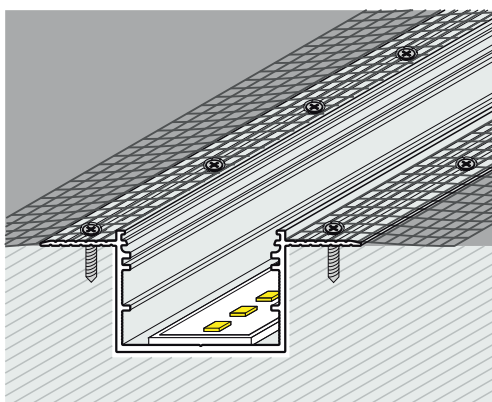
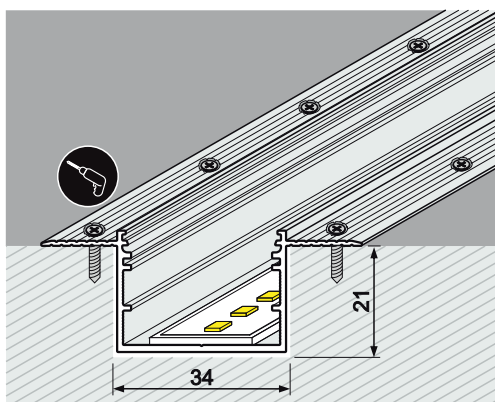

VARIO30-06
VARIO30-07
diffuser / klosz
A9, C9, D9, E9

U9
mounting plate
 uchwyć U9

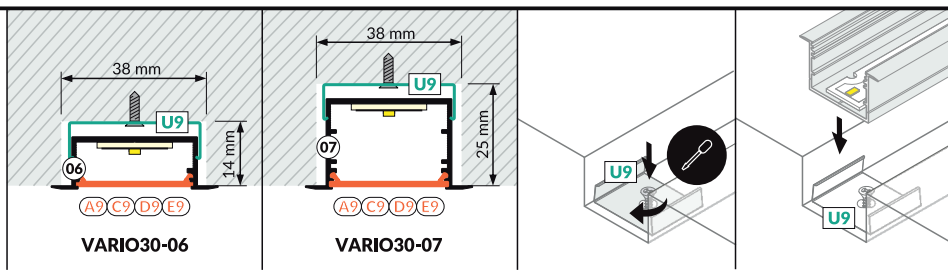

cone U9
mounting plate
 uchwyć U9 cone

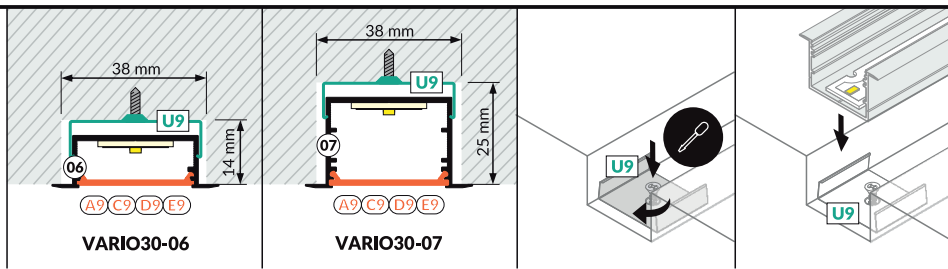

rack U9
mounting plate
 uchwyć U9 rack

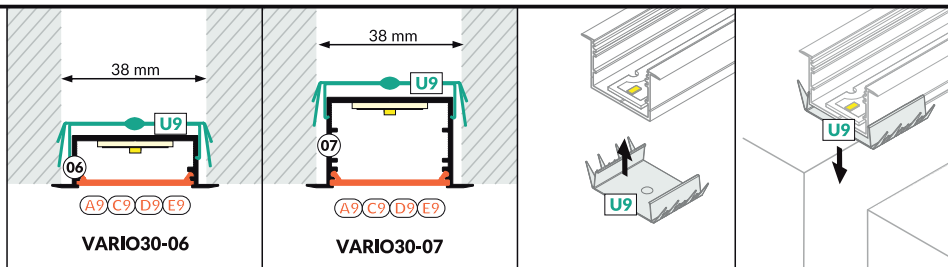

spring U9 mounting plate
 uchwyć U9 sprężyna

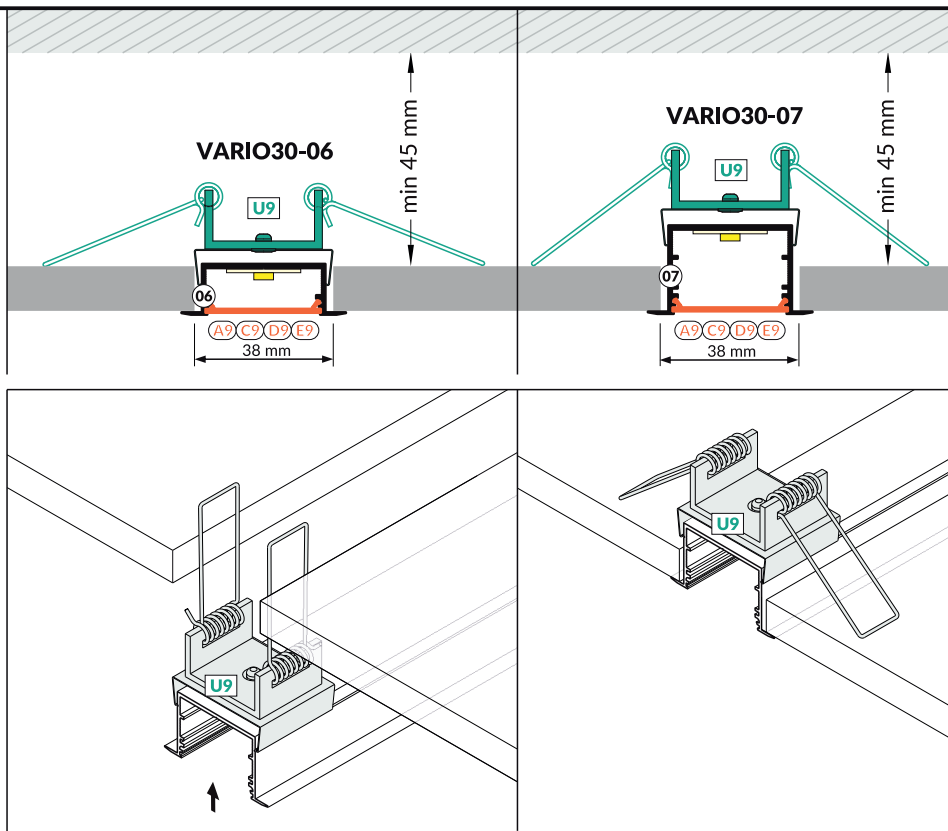

glue
 klej montażowy

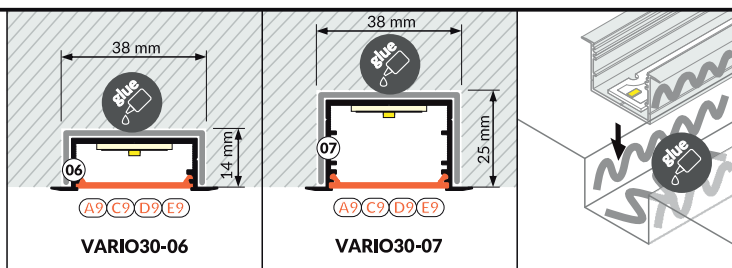

VARIO30-05
VARIO30-07
diffuser / klosz
A9, C9, D9, E9

Available angular connectors:
 Dostępne łączniki kątowe:

VARIO30-05

1. **VARIO30-05 connector 60 deg** / łącznik VARIO30-05 60 st
2. **VARIO30-05 connector 90 deg** / łącznik VARIO30-05 90 st
3. **VARIO30-05 connector 90 deg bent** / łącznik VARIO30-05 90 st gięty
4. **VARIO30-05 connector 120 deg** / łącznik VARIO30-05 120 st
5. **VARIO30-05 connector 135 deg** / łącznik VARIO30-05 135 st
6. **VARIO30-05 connector 180 deg** / łącznik VARIO30-05 180 st
7. **VARIO30-05 connector 270 deg bent** / łącznik VARIO30-05 270 st gięty

VARIO30-07

1. **VARIO30-07 60 connector deg** / łącznik VARIO30-07 60 st
2. **VARIO30-07 90 connector deg** / łącznik VARIO30-07 90 st
3. **VARIO30-07 90 connector deg bent** / łącznik VARIO30-07 90 st gięty
4. **VARIO30-07 120 connector deg** / łącznik VARIO30-07 120 st
5. **VARIO30-07 135 connector deg** / łącznik VARIO30-07 135 st
6. **VARIO30-07 180 connector deg** / łącznik VARIO30-07 180 st
7. **VARIO30-07 270 connector deg bent** / łącznik VARIO30-07 270 st gięty

CONNECTION POSSIBILITIES
MOŻLIWOŚCI ŁĄCZENIA



60°



90°



90° bent / gięty



120°



135°



180°



270° bent / gięty

VARIO30-05
VARIO30-07
diffuser / klosz
A9, C9, D9, E9

VARIO30-07 180 deg
 łącznik VARIO30-07 180 st

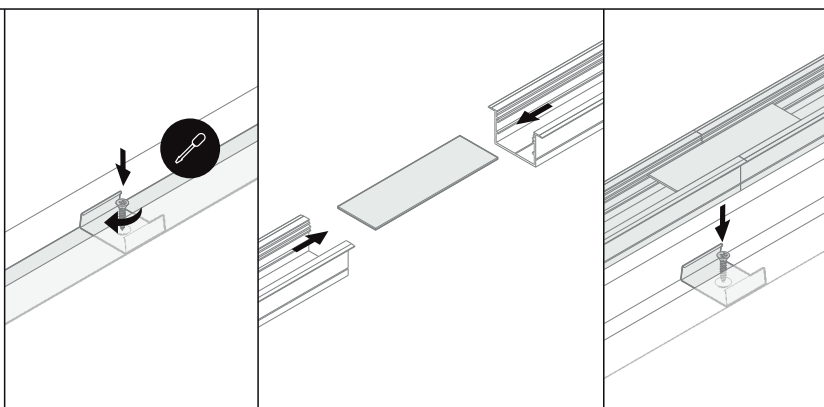

VARIO30-05
VARIO30-07
diffuser / klosz
A9, C9, D9, E9

VARIO30-07 90 deg
 łącznik VARIO30-07 90 st

Every connector is installed similarly to LINEA20 connector 90 deg.
 Każdy łącznik montowany jest analogicznie do łącznika LINEA-IN20 90 st.

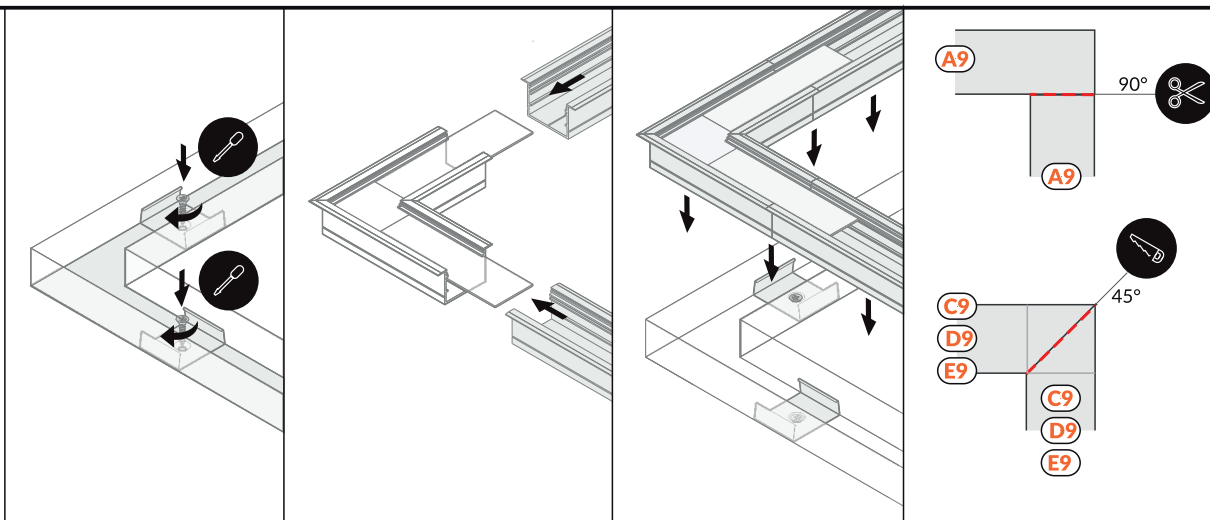

X POWER SUPPLY / ZASILANIE

VARIO30-04
VARIO30-05
VARIO30-06
VARIO30-07
diffuser / klosz
A9, C9, D9, E9

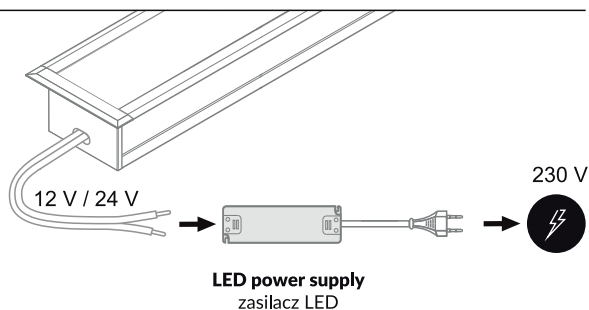

ACCESSORIES / AKCESORIA

power switches / włączniki
controller + remote / sterownik + pilot
movement sensors / czujniki ruchu